

# Riferimento

LAMILUX CI-System Glaselement FE rund



Harbour Terminal "Hafendüne", Norderney (Germany)

## Essential info

Place / Country:	Norderney, Germany
Year:	2018
Building Type:	Harbour Terminal
Solutions:	CI System Glass Element FE in round design

The newly built harbour terminal on Norderney is modern and flooded with daylight thanks to LAMILUX Glass Elements in round design. A total of 21 Glass Elements were installed above the reception hall and the administration offices. 16 of these have a diameter of 100cm and the remaining 5 have a diameter of 180cm.

## LAMILUX HEINRICH STRUNZ GMBH

Zehstraße 2 - Postfach 1540 - 95105 Rehau/Germania - Tel: +49/(0)92 83/5 95-0 - Fax: +49/(0)92 83/5 95-29 0  
E-Mail: [information@lamilux.de](mailto:information@lamilux.de) - [www.lamilux.de](http://www.lamilux.de)

# Riferimento

LAMILUX CI-System Glaselement FE rund



Harbour Terminal "Hafendüne", Norderney (Germany)

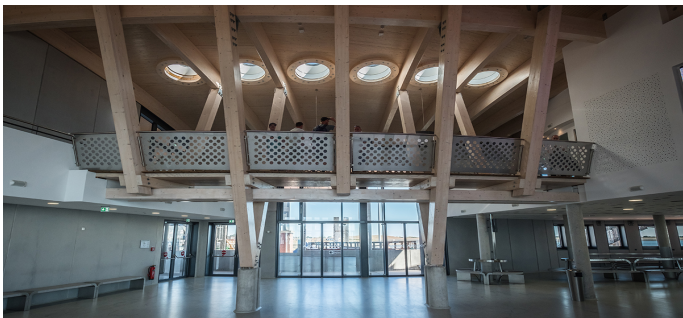

## LAMILUX HEINRICH STRUNZ GMBH

Zehstraße 2 - Postfach 1540 - 95105 Rehau/Germania - Tel: +49/(0)92 83/5 95-0 - Fax: +49/(0)92 83/5 95-29 0

E-Mail: [information@lamilux.de](mailto:information@lamilux.de) - [www.lamilux.de](http://www.lamilux.de)